

High pressure needle valve, article 69-ST diameter G 1/8" up to G 2"

High pressure needle valve with adjustable gland packing for accurate dosing and regulation of even the smallest flow rates. Usage in industrial systems, in which flowing liquids or gaseous media have been shut off. This can also be done under high pressure. The direction is indicated by an arrow.

Please observe the pressure reduction from temperatures over +50 °C !

☞ **Both sides cylindric female thread acc. to EN 228-1 (DIN 259)**

Steel version (body outside burnished)



	ambient -20°C .. +60°C
	medium -20°C .. +350°C

Before risk of frost empty the valve and ensure that the valve is depressurized. Freezing of the fluid may seriously damage the valve.

diagram pressure drops

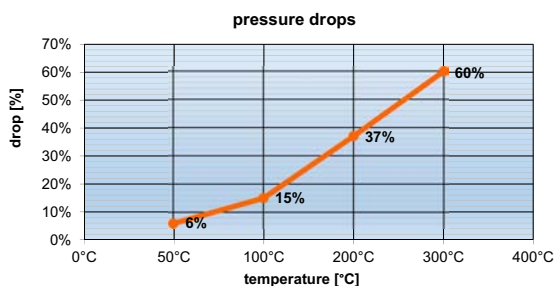

temperature	pressure drop %	max. pressure article 69-ST (1/8" - 1/2")	max. pressure article 69-ST (3/4" - 1")	max. pressure article 69-ST (1 1/4")	max. pressure article 69-ST (1 1/2" - 2")
50° C	6%	376,0 bar	188,0 bar	150,4 bar	112,8 bar
100° C	15%	340,0 bar	170,0 bar	136,0 bar	102,0 bar
200° C	37%	252,0 bar	126,0 bar	100,8 bar	75,6 bar
300° C	60%	160,0 bar	80,0 bar	64,0 bar	48,0 bar

Article 69-ST

Pos.	description	material
1	body	steel 1.0711 (9 S 20 K)
2	stem	stainless steel 1.4104
3	regulating disc	stainless steel 1.4104
4	head piece	steel 1.0711 (9 S 20 K)
5	sealing ring	steel 1.0711 (9 S 20 K)
6	lower gland	stainless steel 1.4104
7	gland packing	graphite (adjustable)
8	upper gland	steel 1.0711 (9 S 20 K)
9	union nut	steel 1.0711 (9 S 20 K)
10	hand wheel	G 1/8" - G 3/4" pressed plastic G 1" - G 2" pressed steel
11	hand wheel nut	

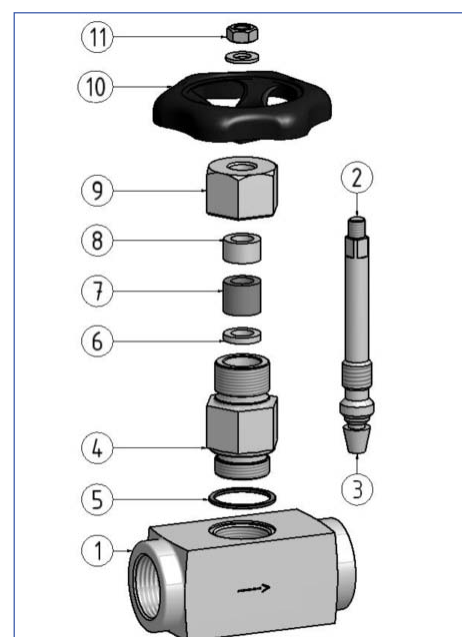

High pressure needle valve, article 69-ST

diameter G 1/8" up to G 2"

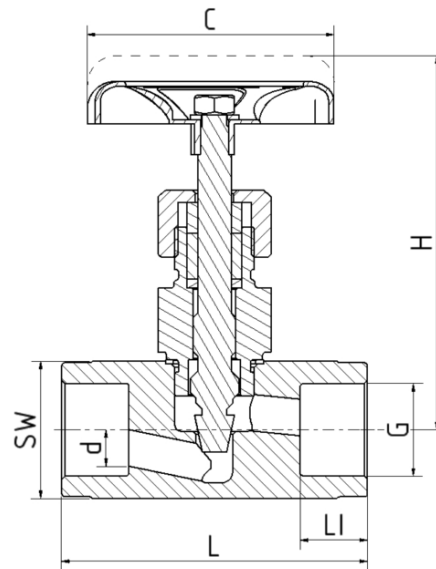

diameter	article number	L (mm)	H (mm)	LI (mm)	SW (mm)	C (mm)	d (mm)	pressure range (bar)	Kv-value [m³/h]	weight (kg)
	69-ST steel 1.0711									
G 1/8"	06.1302.4.60	45	72	11	25	50	4	400	0,33	0,31
G 1/4"	06.1302.4.61	55	72	15	25	50	5	400	0,42	0,31
G 3/8"	06.1302.4.62	55	72	15	25	50	6	400	0,53	0,31
G 1/2"	06.1302.4.63	60	77	17	30	63	7	400	0,66	0,42
G 3/4"	06.1303.4.65	75	99	19	35	63	9	200	1,31	0,73
G 1"	06.1303.4.67	100	110	21	45	90	12	200	2,20	1,50
G 1 1/4"	06.1304.4.68	110	145	22	60	100	15	160	3,00	2,77
G 1 1/2"	06.1305.4.69	130	145	24	70	100	22	120	7,50	4,17
G 2"	06.1305.4.71	130	145	28	70	100	22	120	7,50	7,00