

2-way threaded ball-valve, article 411-MS with drain

Diameter G 1/2" up to G 2"

Threaded ball valve with drain connection on both sides, including drain cock (rotatable) and screw plug including seals. Drain cock can be optional mounted right / left. Ball with full bore, operation by lever.

For general, simple industrial use. Suitable for neutral gaseous and liquid media (no steam).

- Both sides female thread according to ISO 228-1 (BSPP)
- Body outside nickel-plated

article 411-MS

incl. 1 x screw plug / sealing washer
1 x drain cock / sealing washer



Pos.	Description	Material
1	Body	Brass CW 617N nickel plated
2	Threaded end	Brass CW 617N nickel plated
3	Ball	Brass CW 617N chrome plated
4	Stem	Brass CW 614N
5	Ball seal	PTFE profile shells
6	Stem seal	2 x O-ring VITON / NBR
7	Pressure screw	Brass
8	Lever	Steel, red
9	Lever screw	Steel Fe CB4 zinc plated
10	Sealing	Aluminium
11	Screw plug	Brass CW 614N nickel plated
12	Drain cock	Brass CW 617N

	Ambient	-10° C ... +60° C
	Medium	-20° C ... +110° C

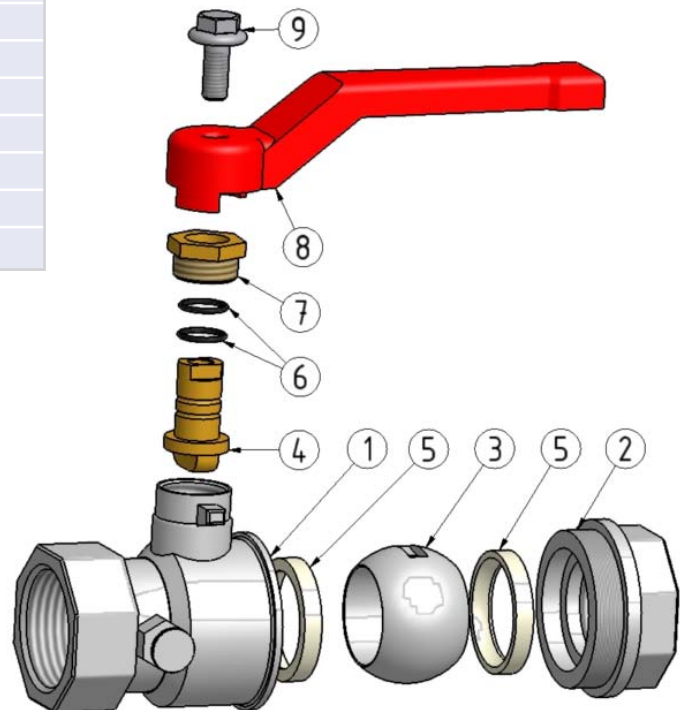
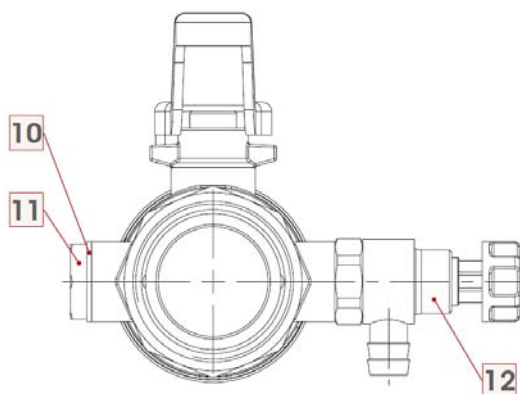

2-way threaded ball-valve, article 411-MS with drain

Diameter G 1/2" up to G 2"

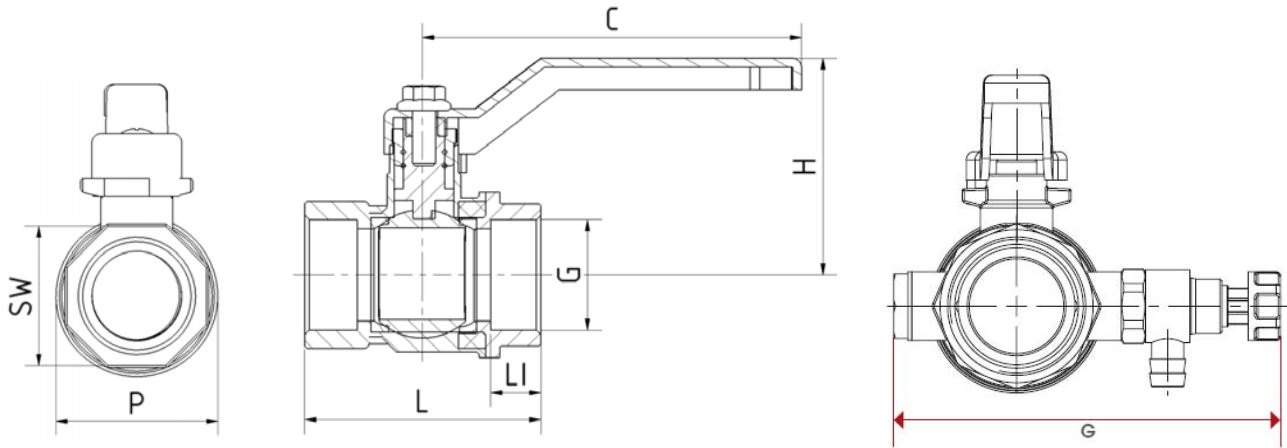

Diameter	Article-No.:	L (mm)	LI (mm)	H (mm)	G (mm)	C (mm)	SW (mm)	P (mm)	Pressure rating max (bar)	Weight (kg)
	411-MS with drain									
G 1/2"	26.3901.0.63	53	12	40	84	80	25	29,0	25	0,21
G 3/4"	26.3901.0.65	58	12	54	89	113	31	36,0	25	0,28
G 1"	26.3901.0.67	71	15	57	96	113	38	43,0	25	0,47
G 1 1/4"	26.3901.0.68	81	16	73	104	138	47	53,0	20	0,68
G 1 1/2"	26.3901.0.69	93	18	78	111	138	54	63,0	20	1,07
G 2"	26.3901.0.71	108	19	94	124	158	66	79,0	20	1,73