

2-way ball valve, Article 490-VA

Diameter G 1/4" up to G 4"

2-piece monobloc ball valve with threads, massive design for use in industrial, chemical and petrochemical plants. Different sealing materials are available depending on the level of pressure and/or temperatures, can also be used for the steam range up to +195° C.

- Article 490-VA** PTFE : G 1/4" - G 4" Pressure rating PN 64
 : G 1/4" - G 2" Pressure rating PN 100
Article 490-VA/PC Carbon graphite : G 1/4" - G 1" Pressure rating PN 160
 (Steam range) G 1 1/4" - G 2" Pressure rating PN 120
 G 2 1/2" - G 4" Pressure rating PN 64
Article 490-VA/D Delrin : G 1/4" - G 4" Pressure rating PN 210

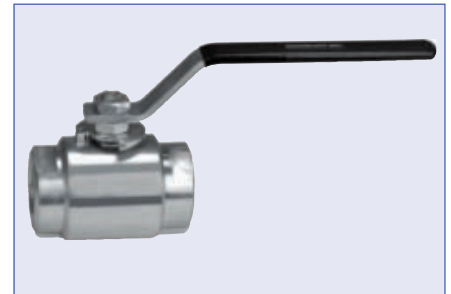

Both sides with long female thread according to DIN 2999 - ISO 7/1 Rp.

Blow-out proof stem with anti-static device.

Operation with hand lever and stop disc in OPEN / CLOSED position.

		Article 490-VA	Article 490-VA/PC	Article 490-VA/D
	API 607	-	BS 6755 - API 6FA	-
	Ambient	-20° C ... +60° C	-20° C ... +60° C	-20° C ... +60° C
	Medium	-20° C ... +180° C	-20° C ... +200° C optimal from +60° C ... +200° C	-20° C ... +70° C

Pos.	Description	Material
1	Body	Stainless steel AISI 316L
2	Female end	Stainless steel AISI 316L
3	Ball	Stainless steel AISI 316L
4	Stem	Stainless steel AISI 316L
5	<u>Ball seal:</u>	
	Article 490-VA:	PTFE
	Article 490-VA/PC:	PTFE and carbographite
	Article 490-VA/D:	Delrin
6	Seat seal	PTFE
7	Upper sealing ring	PTFE
8	Upper seal	PTFE
9	Gland washer	Stainless steel
10	Belleville washers	Stahl 50CrV4
11	Lever	Stainless steel
12	Stop pin	Stainless steel
13	Pin	Stainless steel
14	Stem retaining nut	Stainless steel
15	Locking nut	Stainless steel

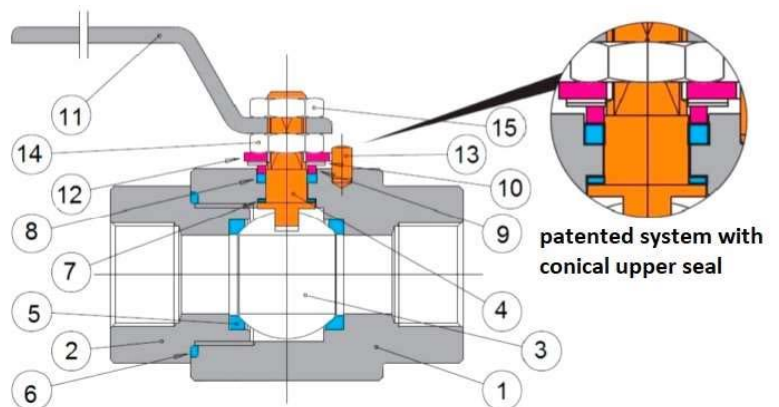

Options:

- ♦ Atex II 2 G/D
- ♦ free of oil and grease
- ♦ with female NPT thread ANSI B1.20.1
- ♦ with socket weld ANSI B16.11
- ♦ with butt weld ANSI B16.25

2-way ball valve, Article 490-VA

Diameter G 1/4" up to G 4"

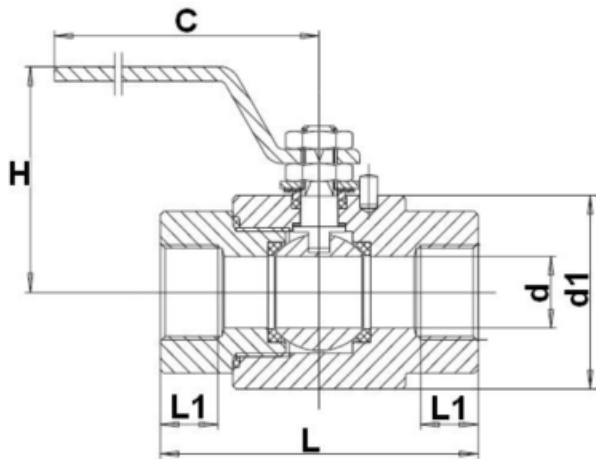
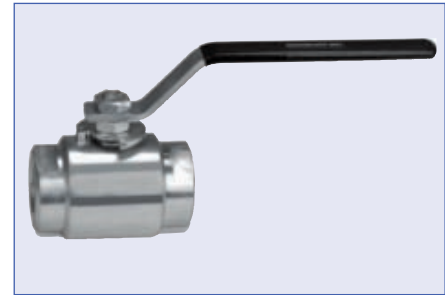

While welding the SW and BW extensions nipples, cool the valve body in order not to damage the seals. The body temperature must NEVER exceed 120° C. Slags and impurities must NEVER penetrate inside the valve.

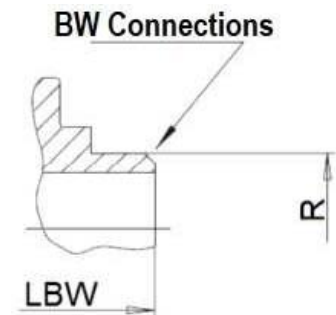
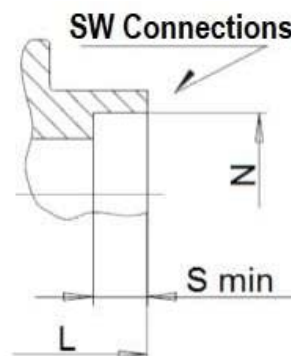

Diameter	L (mm)	LI (mm)	H (mm)	C (mm)	d (mm)	d1 (mm)	N (mm)	S (mm)	LBW (mm)	R (mm)
G 1/4"	67	11,0	72	148	10	42	14,30	9,53	95	13,7
G 3/8"	67	11,4	72	148	10	42	17,80	9,53	95	17,2
G 1/2"	75	15,0	75	148	15	50	22,00	9,53	105	21,3
G 3/4"	90	16,3	85	180	20	60	27,30	12,70	125	26,7
G 1"	105	19,1	95	180	25	68	34,00	12,70	140	33,4
G 1 1/4"	120	21,4	100	240	30	81	42,80	12,70	160	42,2
G 1 1/2"	135	21,4	105	240	38	94	48,90	12,70	180	48,3
G 2"	155	25,7	115	280	48	105	61,40	15,88	220	60,3
G 2 1/2"	190	30,2	130	380	65	130	73,81	15,22	250	73,1
G 3"	205	33,3	145	380	73	150	90,00	15,88	280	88,9
G 4"	230	39,3	200	470	94	185	115,70	19,10	330	114,3

ENG_490-VA_2021, Rev. 0

2-way ball valve, Article 490-VA

Diameter G 1/4" up to G 4"

Diameter	Kv-Value	Weight (kg)		Pressure rating up to max. (bar)			Starting torques (breakaway torques) in Nm PN - bar				
		SW (kg)	BW (kg)	490-VA Sealing PTFE	490-VA/PC Sealing PTFE/Carbon graphite	490-VA/D Sealing Delrin	0	64	100	160	210
G 1/4"	11	0,610	0,630	100	160	210	10	15,0	17,0	19,5	23,4
G 3/8"	11	0,615	0,650	100	160	210	10	15,0	17,0	19,5	23,4
G 1/2"	20	0,930	1,050	100	160	210	12	18,6	22,6	24,7	27,6
G 3/4"	60	1,550	1,600	100	160	210	16	23,0	25,2	26,6	30,0
G 1"	100	2,265	2,350	100	160	210	21	27,0	29,6	31,3	34,8
G 1 1/4"	130	3,300	3,400	100	120	210	54	80,0	88,0	98,0	110,0
G 1 1/2"	170	4,850	5,400	100	120	210	65	83,6	92,9	105,0	117,0
G 2"	280	6,490	6,800	100	120	210	86	126,6	131,0	145,0	160,0
G 2 1/2"	510	13,000	13,400	64	64	210	140	190,0	210,0	250,0	380,0
G 3"	770	17,000	17,500	64	64	210	183	240,0	260,0	305,0	380,0
G 4"	1200	24,000	24,500	64	64	210	270	350,0	389,0	455,0	505,0

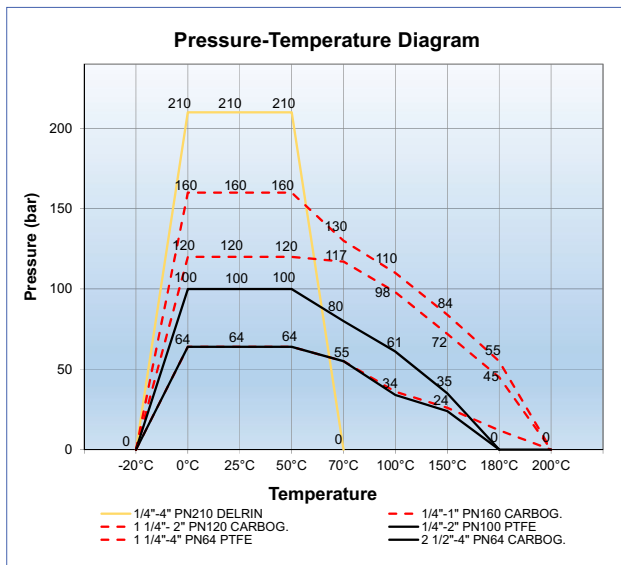

PTFE — The diagram is not valid for dangerous gases

RTFE+CRB - - - -
on request

Diameter	Article-No.		
	490-VA Sealing PTFE	490-VA/PC Sealing PTFE/Carbon graphite	490-VA/D Sealing Delrin
G 1/4"	280.3967.6.61	280.3968.6.61DKP	280.3969.6.61DDR
G 3/8"	280.3967.6.62	280.3968.6.62DKP	280.3969.6.62DDR
G 1/2"	280.3967.6.63	280.3968.6.63DKP	280.3969.6.63DDR
G 3/4"	280.3967.6.65	280.3968.6.65DKP	280.3969.6.65DDR
G 1"	280.3967.6.67	280.3968.6.67DKP	280.3969.6.67DDR
G 1 1/4"	280.3967.6.68	280.3988.6.68DKP	280.3969.6.68DDR
G 1 1/2"	280.3967.6.69	280.3988.6.69DKP	280.3969.6.69DDR
G 2"	280.3967.6.71	280.3988.6.71DKP	280.3969.6.71DDR
G 2 1/2"	280.3966.6.72	280.3966.6.72DKP	280.3969.6.72DDR
G 3"	280.3966.6.73	280.3966.6.73DKP	280.3969.6.73DDR
G 4"	280.3966.6.75	280.3966.6.75DKP	280.3969.6.75DDR