

2-way ball valve, Article 430-MS with pneumatic actuator Diameter G 1/2" up to G 2"

on request also
up to diameter G 4"

2-way ball valve with threads and standardized interface according to ISO 5211 for mounting of pneumatic or electrical actuators. Pressure class up to PN 25, full bore, both sides 100% tight closing. Double shaft seal by two O-rings and self-lubricating PTFE thrust ring, PTFE ball seals spring-loaded by FKM O-rings. This combination guarantees permanently low torques and softly actuation.

Suitable for gaseous and liquid media (no steam) considering material resistance brass.

- both sides female threads acc. to ISO 228-1, UNI 7/1, EN 10226

Unit (ball valve / actuator) is mounted ready for connection including functional test.



• Design Standard	DIN EN 12516-1
• Housing strength	DIN EN 12516-2
• Design pressure	PN 25
• Marking	EN 19, MSS SP-25
• Inspection / test	DIN EN 12266 P10 / P11 / P12

	ATEX CE II 2 G/D on request
	Ambient -10° C ... +60° C
	Medium -15° C ... +90° C short-term up to +120° C

Pos.	Description	Material
1	Body	Brass CW 617N
2	Threaded ends	Brass CW 617N
3	Ball	Brass CW 617N
4	Stem	Brass CW 617N
5	Ball sealing	PTFE profile shells
6	Seat spring loaded	2 x O-Ring VITON
7	Thrust ring	PTFE
8	Stem seal	FKM (VITON)
9	Stem seal	HNBR

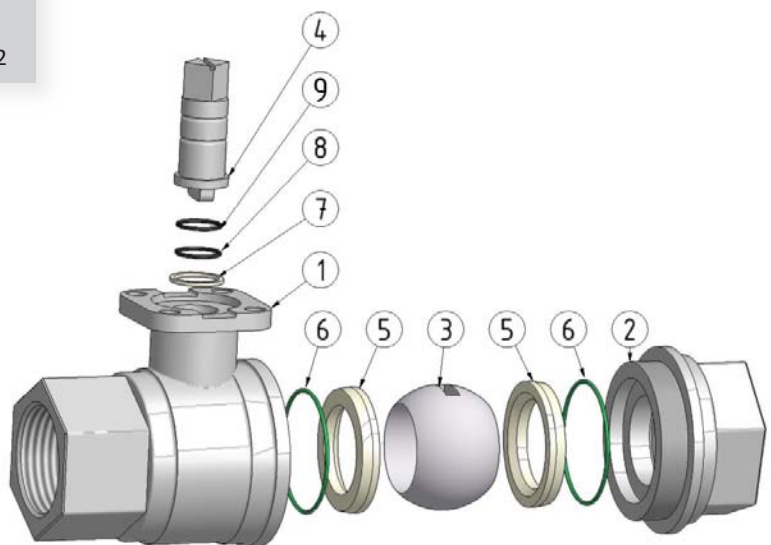

Operating-variant:

electrical actuator

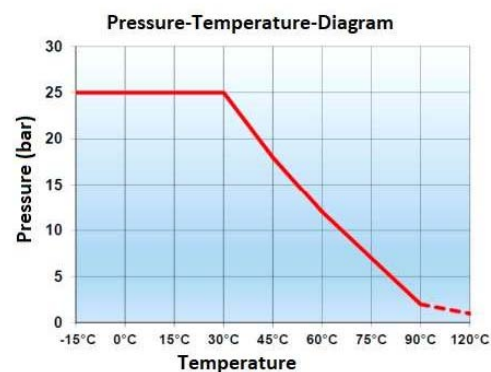

2-way ball valve, Article 430-MS with pneumatic actuator Diameter G 1/2" up to G 2"

Ball valve and pneumatic actuator each enable direct, backlash-free assembly due to their standardized interfaces according to ISO 5211. Modern industrial design and compact construction characterize this pneumatic rotary actuator series. High-quality materials and the robust, reliable design guarantee high availability in daily use.

Depending on the process requirements, there are two versions to choose from:

Function double-acting = Pressurization of the air chambers alternately on both sides

Function single-acting = Pressurization of only one air chamber, resetting by built-in spring assemblies (optionally spring-opening or spring-closing)

Quality of the control medium filtered compressed air according to DIN/ISO 8573-1, class 4.

The unit is always delivered adjusted and tested ready for operation.

Further information on the pneumatic actuators can be found in the individual data sheets.

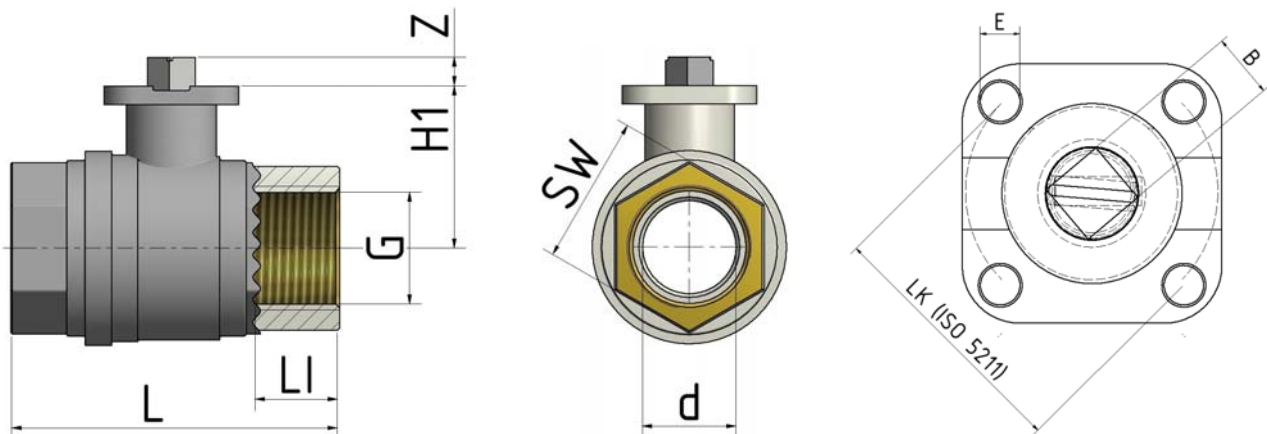

Diameter	L (mm)	LI (mm)	H1 (mm)	Z (mm)	SW (mm)	d (mm)	B (mm)	E (mm)	LK ISO 5211	Starting torque			Weight (kg)
										6,0 bar	10,0 bar	25,0 bar	
G 1/2"	61,0	16,0	32,0	9,0	25,0	15,0	9,0	6,0	F03	3,5 Nm	3,9 Nm	4,3 Nm	0,326
G 3/4"	70,0	16,5	36,0	9,0	31,0	20,0	9,0	6,0	F03	4,1 Nm	4,7 Nm	5,0 Nm	0,546
G 1"	84,0	20,0	44,0	9,0	38,0	25,0	9,0	6,0	F03	4,7 Nm	5,1 Nm	5,5 Nm	0,911
G 1 1/4"	97,0	25,0	49,0	9,0	47,0	32,0	9,0	6,0	F03	5,5 Nm	6,6 Nm	7,5 Nm	1,28
G 1 1/2"	108,0	27,5	54,0	9,0	54,0	40,0	9,0	6,0 / 7,0	F03 / F05	7,8 Nm	8,5 Nm	9,5 Nm	1,876
G 2"	130,0	30,5	62,0	9,0	66,0	50,0	9,0	6,0 / 7,0	F03 / F05	11,0 Nm	12,8 Nm	14,5 Nm	3,025

Diameter	1/2"	3/4"	1"	1 1/4"	1 1/2"	2"
Ø	15,0	20,0	25,0	32,0	40,0	50,0
KV-Value	15,0	28,0	39,0	84,0	156,0	243,0

KV value = corresponds to the water flow rate in (m³/h) at a pressure difference of about one bar

2-way ball valve, Article 430-MS with pneumatic actuator Diameter G 1/2" up to G 2"

actuator longitudinal mounted as standard, if transverse mounting desired, please indicate at ordering.

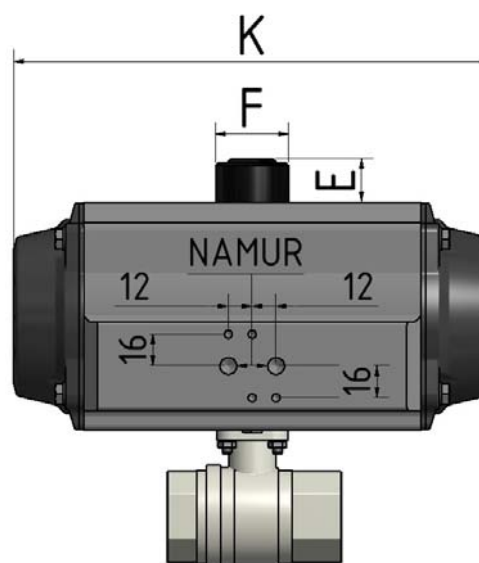
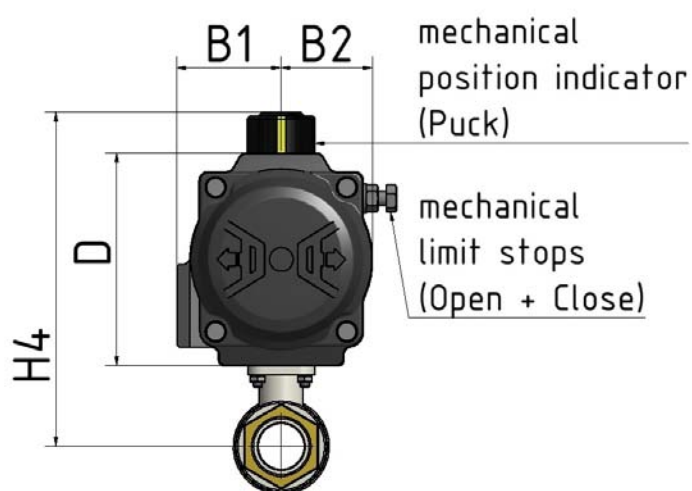

- double acting -

Diameter	Article-No.	Actuator design up to max. 20 bar								
		H4 (mm)	D (mm)	B1 (mm)	B2 (mm)	K (mm)	F (mm)	E (mm)	Air connection	Weight (kg)
G 1/2"	280.3974.0.63	118	66	35,5	26,5	118,0	37	20	G 1/8"	1,08
DR 10	86.8200.5.10									
G 3/4"	280.3974.0.65	122	66	35,5	26,5	118,0	37	20	G 1/8"	1,30
DR 10	86.8200.5.10									
G 1"	280.3974.0.67	130	66	35,5	26,5	118,0	37	20	G 1/8"	1,67
DR 10	86.8200.5.10									
G 1 1/4"	280.3974.0.68	154	85	48,5	36,0	153,5	37	20	G 1/8"	2,89
DR 30	86.8200.5.30									
G 2"	280.3974.0.69	159	85	48,5	36,0	153,5	37	20	G 1/8"	3,49
DR 30	86.8200.5.30									
G 1 1/4"	280.3974.0.71	162	85	48,5	36,0	153,5	37	20	G 1/8"	4,64
DR 30	86.8200.5.30									

2-way ball valve, Article 430-MS with pneumatic actuator Diameter G 1/2" up to G 2"

actuator longitudinal mounted as standard, if transverse mounting desired, please indicate at ordering.

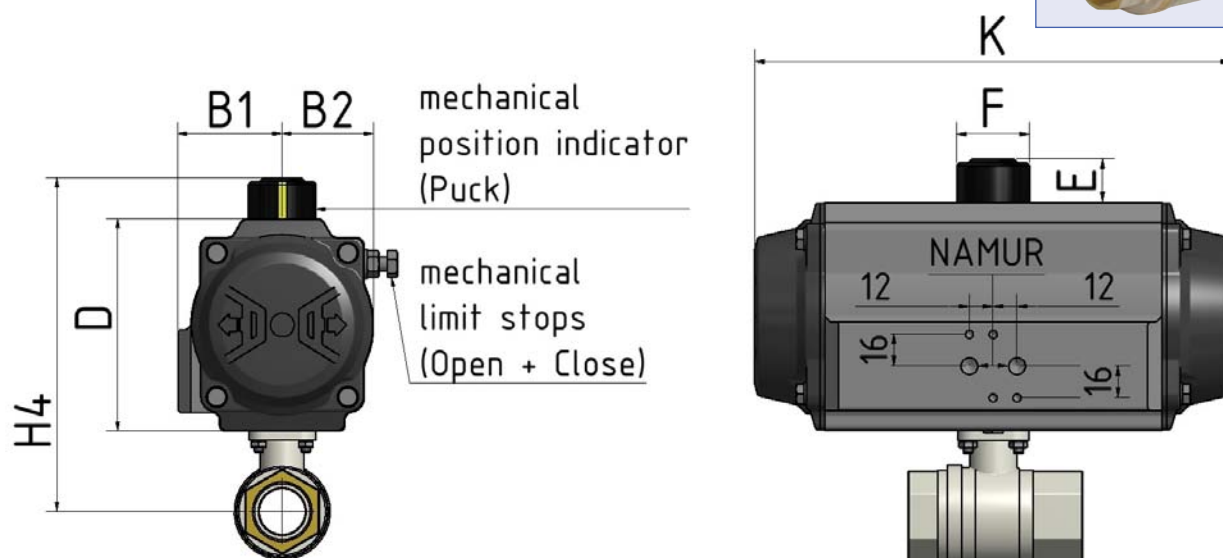

- single acting -
Spring closing Spring opening

Diameter	Article-No.	Actuator design up to max. 20 bar								Air connection	Weight (kg)
		H4 (mm)	D (mm)	B1 (mm)	B2 (mm)	K (mm)	F (mm)	E (mm)			
G 1/2"	280.3974.0.63	137	85	48,5	36,0	153,5	37	20	G 1/8"	2,14	
SC 30	86.8201.5.30-10 86.8202.5.30-10										
G 3/4"	280.3974.0.65	141	85	48,5	36,0	153,5	37	20	G 1/8"	2,36	
SC 30	86.8201.5.30-10 86.8202.5.30-10										
G 1"	280.3974.0.67	149	85	48,5	36,0	153,5	37	20	G 1/8"	2,73	
SC 30	86.8201.5.30-10 86.8202.5.30-10										
G 1 1/4"	280.3974.0.68	154	85	48,5	36,0	153,5	37	20	G 1/8"	3,13 3,07	
SC 30	86.8201.5.30-12 86.8202.5.30-09										
G 1 1/2"	280.3974.0.69	176	102	50,5	42,5	203,5	37	20	G 1/8"	4,86	
SC 60	86.8201.5.60-10 86.8202.5.60-10										
G 2"	280.3974.0.71	184	102	50,5	42,5	203,5	37	20	G 1/8"	6,07 5,95	
SC 60	86.8201.5.60-12 86.8202.5.60-08										