

shut-off valve, article 64-ST cutting ring connection 6L up to 12L

High-pressure shut-off valves with adjustable gland packing for use in industrial systems in which flowing liquids or gaseous media have been shut off. This can also be done under high pressure. The direction of flow is indicated at the body by an arrow.

Please observe the pressure reduction from temperatures over +50 °C !

☞ **Both sides cutting ring connection acc. to DIN 2353 / EN ISO 8434-1 light duty series.**

Body forged steel, burnished



| | | |
|--|---------|--------------------|
| | ambient | -20° C ... +60° C |
| | medium | -20° C ... +400° C |

Before risk of frost empty the valve and ensure that the valve is depressurized. Freezing of the fluid may seriously damage the valve.

diagram pressure drops

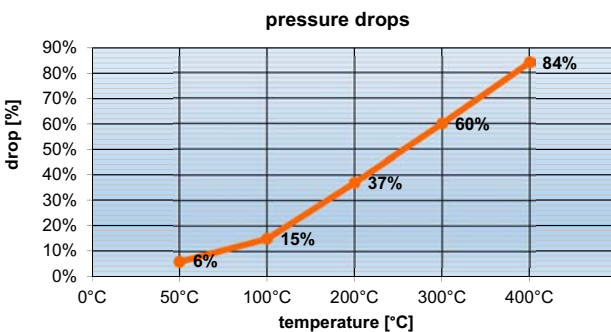

| temperature | pressure drop % | max. pressure article 64-ST |
|-------------|-----------------|-----------------------------|
| 50° C | 6% | 296,1 bar |
| 100° C | 15% | 267,75 bar |
| 200° C | 37% | 198,45 bar |
| 300° C | 60% | 126,0 bar |
| 400° C | 84% | 50,4 bar |

Article 64-ST

| Pos. | description | material |
|------|-----------------|-----------------------------|
| 1 | body | steel 1.0460 |
| 2 | stem | stainless steel 1.4104 |
| 3 | regulating disc | stainless steel 1.4104 |
| 4 | lower gland | steel 1.0711 (9 S 20 K) |
| 5 | gland packing | graphite |
| 6 | upper gland | steel 1.0711 (9 S 20 K) |
| 7 | union nut | steel 1.0711 (9 S 20 K) |
| 8 | hand wheel | hard pressed plastic, black |
| 9 | hand wheel nut | |

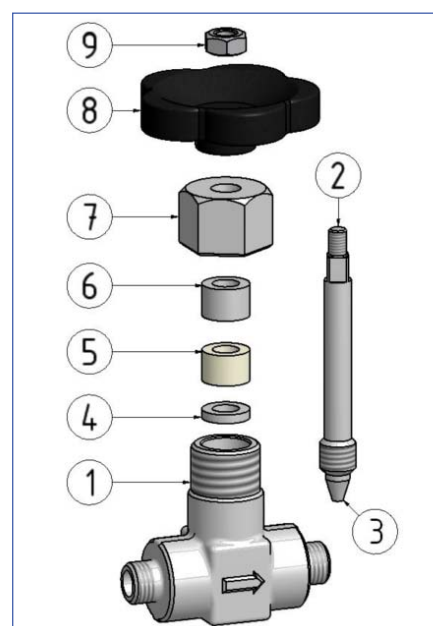

shut-off valve, article 64-ST

cutting ring connection 6L up to 12L

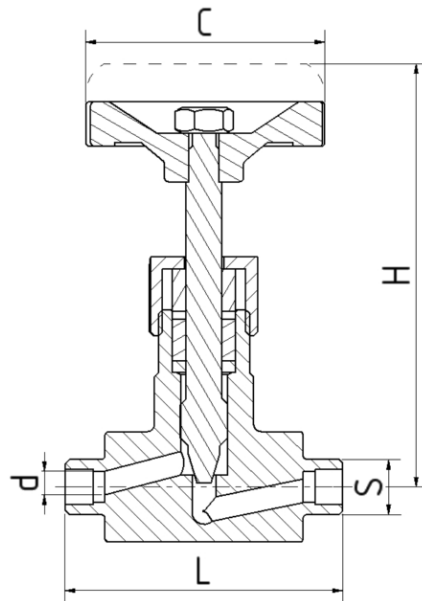

| cutting ring connection S | article no. | | | | | | | |
|---------------------------|--------------------|--------|--------|--------|--------|-----------------------|------------------------------|-------------|
| | 64-ST steel 1.0460 | L (mm) | H (mm) | C (mm) | d (mm) | pressure rating (bar) | Kv-value [m ³ /h] | weight (kg) |
| 6L | 06.1008.4.81-L | 70 | 100 | 63 | 4 | 315 | 0,33 | 0,45 |
| 8L | 06.1008.4.82-L | 70 | 100 | 63 | 5 | 315 | 0,42 | 0,44 |
| 10L | 06.1008.4.83-L | 70 | 100 | 63 | 6 | 315 | 0,53 | 0,50 |
| 12L | 06.1008.4.84-L | 70 | 100 | 63 | 6 | 315 | 0,53 | 0,60 |