

## High pressure shut-off valve, article 61-ST and 61-VA welding ends 10,2 mm (DN 6) up to 26,9 mm (DN 20)



High pressure shut-off valve with adjustable gland packing for use in industrial systems, in which flowing liquids or gaseous media have been shut off. This can also be done under high pressure. The direction is indicated by an arrow.

Please observe the pressure reduction from temperatures over +50 °C !

☞ **Both sides with welding ends, dimensions acc. to ISO 4200**

Steel version (body outside burnished)

	ambient	
	61-ST	-20°C .. +60°C
	61-VA	-40°C .. +60°C
	medium	
	61-ST	-20°C .. +400°C
	61-VA	-40°C .. +250°C special package up to +550°C

### diagram pressure drops

Before risk of frost empty the valve and ensure that the valve is depressurized. Freezing of the fluid may can seriously damage the valve.

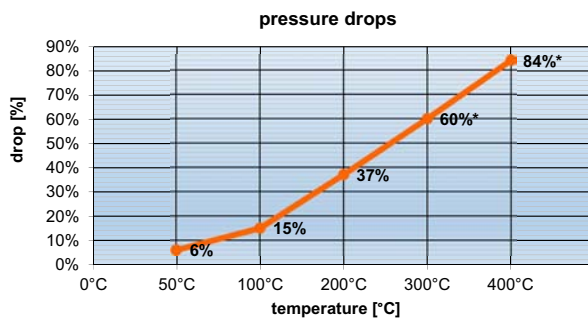

temperature	pressure drop %	max. pressure article 61 (DN 6 - DN 8)	max. pressure article 61 (DN 10 - DN 15)	max. pressure article 61 (DN 20)
50° C	6%	601,4 bar	300,8 bar	235,0 bar
100° C	15%	544,0 bar	272,0 bar	212,5 bar
200° C	37%	403,2 bar	201,6 bar	157,5 bar
*300° C	60%	256,0 bar	128,0 bar	100,0 bar
*400° C	84%	102,4 bar	51,2 bar	40,0 bar

\*only applies for article 61-ST

Article 61		61-ST	61-VA
Pos.	description	material	material
1	body	steel 1.0460	stainless steel 1.4571
2	stem	stainless steel 1.4104	stainless steel 1.4571
3	regulating disc	chrome steel 1.4034	stainless steel 1.4571
4	head piece	steel 1.0711 (9 S 20 K)	stainless steel 1.4571
5	sealing ring	steel 1.0711 (9 S 20 K)	stainless steel 1.4571
6	lower gland	steel 1.0711 (9 S 20 K)	stainless steel 1.4571
7	gland packing	graphite	Teflon
8	upper gland	steel 1.0711 (9 S 20 K)	stainless steel 1.4571
9	union nut	steel 1.0711 (9 S 20 K)	stainless steel 1.4571
10	hand wheel	pressed steel, black	pressed steel, black
11	handwheel nut		

On request body in material 'heat-resistant steel 1.7335' available.

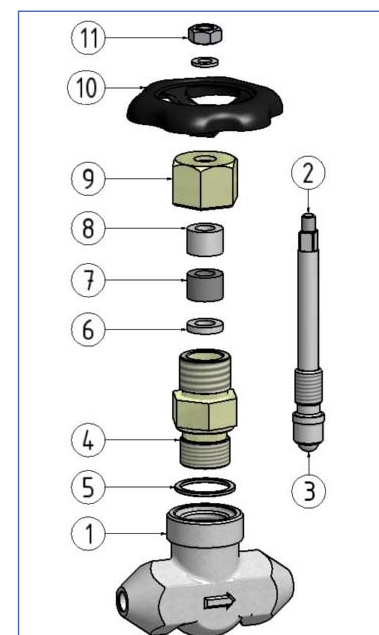

**High pressure shut-off valve, article 61-ST and 61-VA**  
**welding ends 10,2 mm (DN 6) up to 26,9 mm (DN 20)**

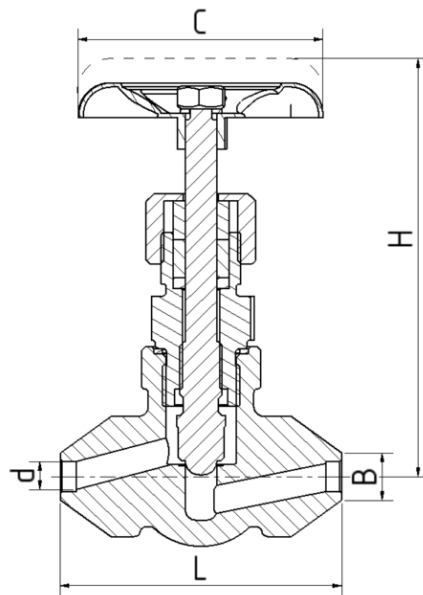

welding ends B (mm)	order number		L (mm)	H (mm)	C (mm)	d (mm)	pressure rating (bar)	Kv-value [m³/h]	weight (kg)
	61-ST steel 1.0460	61-VA 1.4571							
10,2 (DN 6)	06.1012.4.04	06.1012.6.04	80	120	70	6	640	0,53	0,68
13,5 (DN 8)	06.1012.4.06	06.1012.6.06	80	120	70	8	640	0,83	0,66
17,2 (DN 10)	06.1012.4.08	06.1012.6.08	100	135	90	10	320	1,40	1,20
21,3 (DN 15)	06.1012.4.11	06.1012.6.11	130	166	100	15	320	3,00	2,09
26,9 (DN 20)	06.1012.4.13	06.1012.6.13	130	166	100	20	250	3,50	2,53

61-ST, 61-VA\_ENG\_2021\_Rev. 0