

2-way ball valve, Article 415-MS A/A

Diameter G 3/8" up to G 2"

Full bore socket ball valve für die allgemeine, for general, simple industrial use. Suitable for neutral gaseous and liquid media (no steam).

- both sides male threads according to ISO 228-1 (BSP)

- body outside nickel-plated

Operation by lever OPEN / CLOSE

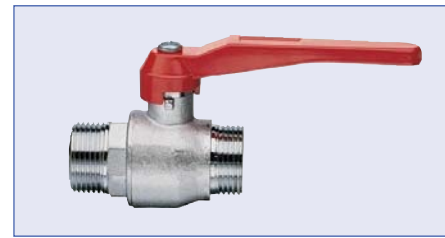

	Ambient	-10° C ... +60° C
	Medium	-20° C ... +110° C

Pos.	Description	Material
1	Body	Brass CW 617N nickel-plated
2	Threaded ends	Brass CW 617N nickel-plated
3	Ball	Brass CW 617N chrome plated
4	Stem	Brass CW 614N
5	Ball seal	PTFE profile shells
6	Stem seal	2 x PTFE-seal seat
7	Pressure screw	Brass
8	Lever	Aluminium, red coated
9	Lever screw	Steel zinc plated

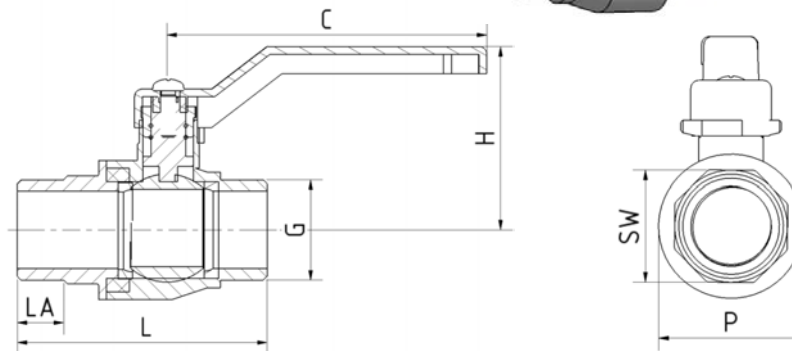
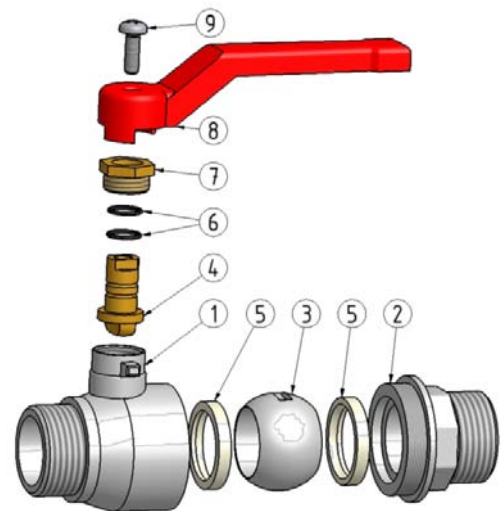

Diameter	Article-No.:	L (mm)	LA (mm)	H (mm)	C (mm)	SW (mm)	P (mm)	Pressure rating bar max	Weight (kg)
	415-MS A/A male thread								
G 3/8"	26.3912.0.62	49,0	9,5	46	92,0	23,0	23,0	40	0,12
G 1/2"	26.3912.0.63	58,5	11,5	51	92,0	29,5	29,5	40	0,15
G 3/4"	26.3912.0.65	65,0	13,0	54	92,0	37,0	37,0	40	0,22
G 1"	26.3912.0.67	76,5	16,5	63	115,0	44,0	44,0	40	0,41
G 1 1/4"	26.3912.0.68	87,0	16,0	77	125,0	55,5	55,5	30	0,61
G 1 1/2"	26.3912.0.69	103,0	18,0	88	150,0	68,0	68,0	30	0,92
G 2"	26.3912.0.71	113,0	20,0	97	150,0	87,0	87,0	30	1,49

Diameter	3/8"	1/2"	3/4"	1"	1 1/4"	1 1/2"	2"
Ball bore Ø	10	15	19	24,5	32	40	50
KV-Value	5,00	10,05	24,56	51,81	68,65	98,83	177,04

415-MS A/A_ENG_2021_Rev.0