

High pressure shut-off valve, article 63-V2A

diameter G 3/8" up to G 1"

High pressure shut-off valve with adjustable gland packing for use in industrial systems, in which flowing liquids or gaseous media have been shut off. This can also be done under high pressure. The direction is indicated by an arrow.

Please observe the pressure reduction from temperatures over +50 °C!

☞ **Both sides with external threads acc. to EN 228-1 (DIN 259), cylindric.**



	ambient	-20°C ... +60°C
	medium	-40°C ... +400°C

Before risk of frost empty the valve and ensure that the valve is depressurized. Freezing of the fluid may seriously damage the valve.

diagram pressure drops

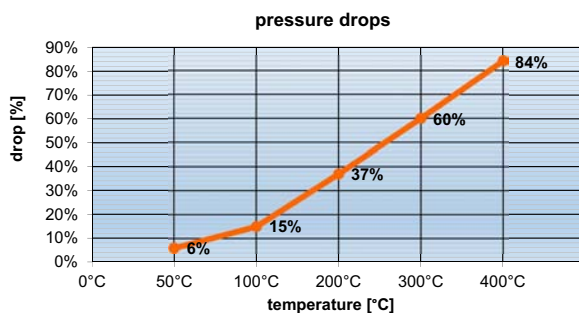

temperature	pressure drop %	max. pressure article 63-V2A (1/4" up to 1/2")	max. pressure article 63-V2A (3/4" up to 1")
50° C	6%	598,5 bar	300,8 bar
100° C	15%	535,5 bar	272,0 bar
200° C	37%	396,9 bar	201,6 bar
300° C	60%	252,0 bar	128,0 bar
400° C	84%	100,8 bar	52,2 bar

Article 63-V2A

Pos.	description	material
1	body	stainless steel 1.4104
2	stem	stainless steel 1.4104
3	regulating disc	chrome steel 1.4034
4	head piece	steel 1.0711 (9 S 20 K)
5	sealing ring	steel 1.0711 (9 S 20 K)
6	lower gland	steel 1.0711 (9 S 20 K)
7	gland packing	graphite
8	upper gland	steel 1.0711 (9 S 20 K)
9	union nut	steel 1.0711 (9 S 20 K)
10	hand wheel	pressed steel, black
11	hand wheel nut	

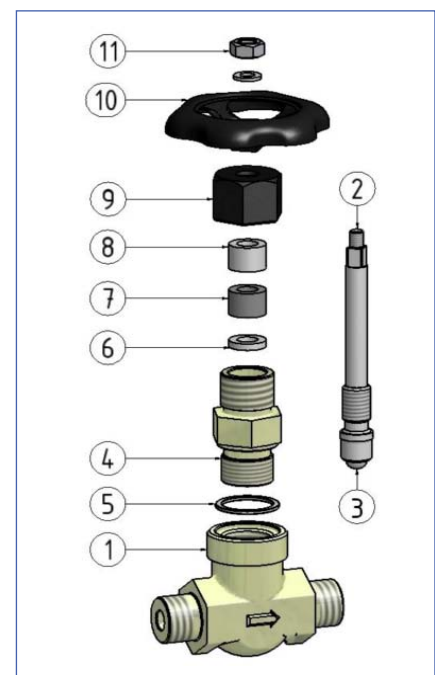

High pressure shut-off valve, article 63-V2A

diameter G 3/8" up to G 1"

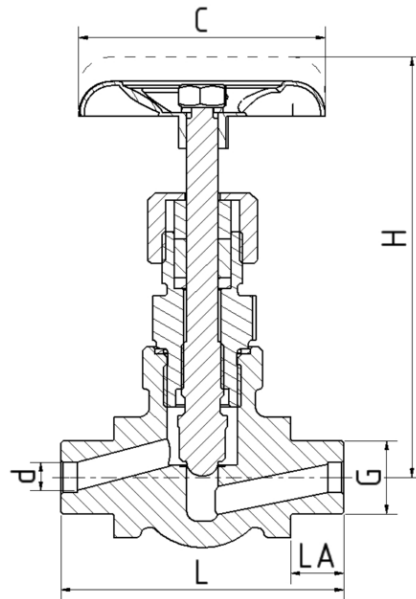

	article number	L (mm)	H (mm)	LA (mm)	C (mm)	d (mm)	pressure rating (bar)	Kv-value [m ³ /h]	weight (kg)
diameter	63-V2A 1.4104								
G 3/8"	06.1016.5.62	80	120	15	70	6	640	0,53	0,65
G 1/2"	06.1016.5.63	80	120	17	70	8	640	0,83	0,66
G 3/4"	06.1015.5.65	100	135	19	90	10	320	1,40	1,45
G 1"	06.1015.5.67	130	166	21	100	15	320	3,00	1,81